

1B - J

1 BEDROOM / 1 BATH

± 542-841 SF / ± 50-78 M²

AVAILABLE ON FLOORS 3, 5-12, 14-34

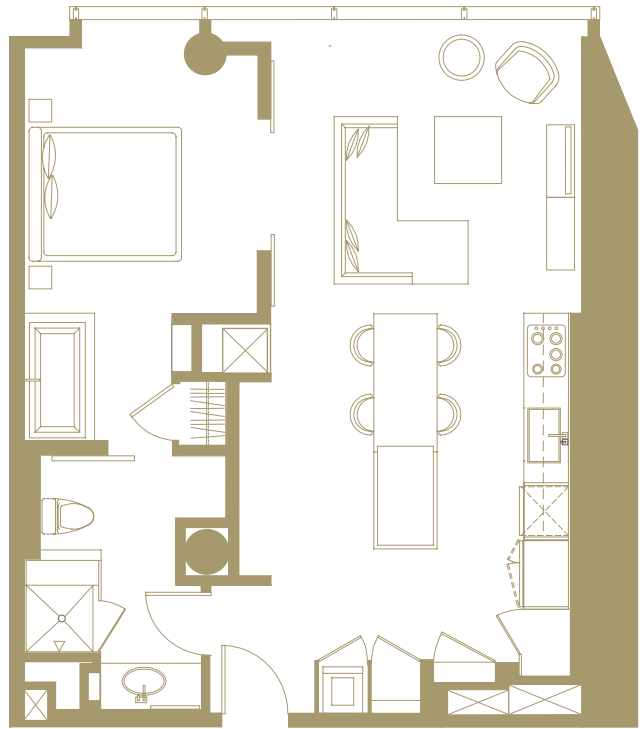

RESIDENCES OFFERED BY:
Pordes Residential

SALES GALLERIES OPEN DAILY / 3726 LAS VEGAS BLVD SOUTH #3603 / 702 748 8285 / VEERTOWERS.COM 🏠

PLANS, ARCHITECTURAL RENDERINGS, SPECIFICATIONS, PRICING AND LOCATIONS ARE SUBJECT TO CHANGE WITHOUT NOTICE. UNAUTHORIZED USE OF THESE PLANS IS STRICTLY PROHIBITED. FURNISHINGS ARE SHOWN FOR ILLUSTRATIVE PURPOSES ONLY AND ARE NOT INCLUDED WITHIN THE UNIT. THIS FLOORPLAN IS REPRESENTATIVE OF THIS UNIT TYPE AND VARIATIONS EXIST BY UNIT. PLEASE REVIEW THE UNIT CONTRACT PLAN AND INSPECT THE UNIT FOR EXACT SPECIFICATIONS AND LOCATIONS. PLAN SHOWN IS NOT TO SCALE. NEITHER CITYCENTER LAND, LLC, NOR ANY AFFILIATE THEREOF ("CITYCENTER") ARE IN ANY WAY OWNERS, SPONSORS, OFFERORS, ISSUERS OR UNDERWRITERS OF, OR RESPONSIBLE OR LIABLE FOR, ANY OFFERING FOR SALE OF THE REAL PROPERTY REFERENCED HEREIN AT VEER TOWERS AND MAKE NO REPRESENTATION, WARRANTY OR GUARANTY OF ANY KIND REGARDING VEER TOWERS, THE OWNER AND OFFEROR. LVT OWNER LLC, USES THE NAME AND TRADEMARKS SUBJECT TO THE TERMS OF A REVOCABLE LICENSE AGREEMENT. THIS IS NOT AN OFFERING IN JURISDICTIONS WHERE PRIOR QUALIFICATION IS REQUIRED UNLESS THE OWNER HAS PREVIOUSLY MET SUCH QUALIFICATIONS. WARNING: THE CALIFORNIA DEPARTMENT OF REAL ESTATE HAS NOT INSPECTED, EXAMINED, OR QUALIFIED THIS OFFERING.